



Welcome to Colors of Music

Welcome and thank you for choosing to participate in the Northstars JV & Junior Winter guards Colors of Music Competition being held on March 14, 2020. Here is some important information we would like to share with you.

The show will be at the **North Syracuse Jr. High**, NOT at the high school.

Our main doors will open for spectators at 1:30 PM. The gym doors will open at 2:30 PM. Our National Anthem will be performed at 3:30 PM with the first team performing at 3:35.

Tickets: Tickets will be available at the door for \$8.00 with discounts for seniors and children.

Guard Check In: Each participating guard will be assigned a homeroom. Because of the computers in the school, an adult guard representative must sign a form as the guard arrives stating the room will be returned to the condition in which it was found and pay for repair or replacement for broken or missing items. A GUARD REPRESENTATIVE MUST ARRIVE WITH THE MEMBERS AND SIGN THE FORM. ROOMS WILL NOT BE ASSIGNED UNTIL THIS HAS BEEN DONE.

Guards should be dropped off at the doors by the Main Entrance of the school at the circle in front. Your guard members will be stamped here and directed to your room. Props and equipment should follow outdoor signs to their drop-off location **The circuit is using Competition Suite and scores and comments will be sent to you through your phone, computer or other digital device.**

Please note only instructors and chaperones will be allowed in the guard area. If you have guard members going home with parents please make arrangements in advance with the parents to meet them in the cafeteria. This is a policy of the Cicero - North Syracuse School District and will be strictly enforced.

Video: Due to copyright restrictions, Mid-York no longer allows recording of shows.

Pre-Performance Announcements: All announcements should be typed and clearly labeled with your guard name and the time of your performance. Announcements should be turned in immediately upon check in. Please clarify wording with announcer when you do a sound check. Email announcements and program info to Larry Schmidt at LarSchmidt@Yahoo.Com

Sound Checks: Sound checks will be allowed from 2:30 PM until 3:25 PM and again from 5:47 - 6:17, during intermission only.

Bus Parking: Once your guard has been dropped off at the guard check in area, your buses will be instructed by our security staff on where to go to unload props and park. We are asking all buses and equipment vehicles to park in the side lot, as there will be no parking on the circle during the show. Buses will be allowed in to pick up your guard after the show.

Equipment: All equipment MUST be carefully padded with special attention to all sabers. All equipment will be inspected before entering the gym.

No props will be checked in before 1:30pm. Props need to be removed after your performance due to the size of our show.

Floors: The guards will be entering the gym from the left side of judges. And they will exit the gym using the doors on the right. Both of these doors are located near the back of the performance floor. When you are folding your floor mat, you will drop it along the left side and pull across to the right.

Cafeteria: The cafeteria will be open as of 1:30 PM with a variety of choices available.

Seating: Guard members, chaperones, and your floor crew will be stamped upon arrival. The Mid-York circuit allows a total of 15 staff, chaperones and floor crew combined per unit. Floor crew will be stamped at the prop entrance. These members will be allowed to view the show from **the back side of the gym** only. Since there will be limited seating for the paying public, please remind your members to sit on the back side of the gym. They will be asked to move if they are sitting on the front side.

Guides: Your group will be escorted as it makes its way from your classroom to the body warm up area. And then you will be instructed to proceed down the hall to the equipment warm up area. **It's the director's responsibility to follow the time schedule.**

Warm Ups: There will be a 7-10 minute body warm up and an 7-10 minute equipment warm up period prior to your performance time. **While we will provide guides, it is the responsibility of the director to make sure their guard arrives for warm ups on time.** As you will notice the equipment warm up area is adjacent to the prop set-up area so please be as quiet and respectful as possible when unloading and loading props.

IMPORTANT NOTICE: the school has installed large speakers hanging from chains over the basketball court. This could be a problem for higher tosses. Also the backboards are not movable, another obstacle to consider. (See picture at end of this document). Call me with any questions.

Retreat: Captains only please. Please have your captain's report to the equipment warm up gym as per the schedule.

Comments & sheets: Please remember to pick up your music CD from the announcers table in the gym. Remember, comments are digital and will be received through competition suite along with the scores.

Awards: All groups from each class will be receiving an award.

The **Post Contest Meetings** will be held in the Large Group Instruction Room (**LGI is located across from the cafeteria**) and will begin during the last exhibition of the evening). There will not be any meetings during intermission. Directors are asked to wait in the south dining area (body warm-up). This will free up the hallway as guards are leaving and parents are cleaning up. Critique will go in show order other than the CNS teams will go last.

Smoking: There is **No Smoking Permitted** on school grounds. Please remind your parents, chaperones and floor crew of this important rule.

Directions :

From the North~ Take Route 81 South, exit 28 Taft Road. Turn right onto Taft Rd/ School will be on your right approx 1 mile. You will go thru 3 lights, school is at the fourth light.

From the South ~ Take Route 81 North, exit 28 Taft Road. Turn left onto Taft Rd. School will be on your right approx. 1 mile. You will go thru 3 lights, school is at the fourth light.

From the West ~(Rochester) Or East (Albany) Take NYS Thruway to exit 36, straight after toll booths to Route 81 North. Take exit 28 Taft Road. Turn left onto Taft Rd. School will be on your right approx 1 mile. You will go thru 3 lights, school is at the fourth light.

If using a GPS the address is:

**North Syracuse Junior High School
5353 W. Taft Road
North Syracuse, NY 13212**

If you need to contact us the day of the show, we can be reached at the following numbers.

Larry Schmidt (315) 402-7318
Cheryl McDonald (315)254-7630

Good Luck to All and Enjoy the Show!

Sincerely;

Larry Schmidt
Northstars Varsity Winterguard Director
315-402-7318
larschmidt@yahoo.com

Cheryl McDonald
CNS Winterguard Parent Group President
Fasttrack0430@yahoo.com
Home Show Coordinators

Colors of Music – CNS JV/Junior Home show March 14, 2020

Guard	Class	Ready	Travel	Body Warm-up start	Body Warm-up end	Travel	EQ Warm-up start	EQ Warm-up end	Travel	Perform Start	Perform End
Nat.Anthem/Announcemt.										3:30	3:35
Central Square	ERA	3:03		3:09	3:16		3:22	3:29		3:35	3:42
Phoenix	ERA	3:10		3:16	3:23		3:29	3:36		3:42	3:49
Southern Tier	ERA	3:17		3:23	3:30		3:36	3:43		3:49	3:56
Vestal	Cadet	3:24		3:30	3:37		3:43	3:50		3:56	4:03
Victor	Cadet	3:31		3:37	3:44		3:50	3:57		4:03	4:10
Laurens Jr	Cadet	3:38		3:44	3:51		3:57	4:04		4:10	4:17
Westmoreland Jr	Cadet	3:45		3:51	3:58		4:04	4:11		4:17	4:24
Jordan Elbridge JV	Cadet	3:52		3:58	4:05		4:11	4:18		4:24	4:31
Pine Grove	Cadet	3:59		4:05	4:12		4:18	4:25		4:31	4:38
Judge Break										4:38	4:43
Vestal	SRA	4:11		4:17	4:24		4:30	4:37		4:43	4:50
Liverpool JV	SRA	4:18		4:24	4:31		4:37	4:44		4:50	4:57
West Genesee	SRA	4:25		4:31	4:38		4:44	4:51		4:57	5:04
Sherburne	SRA	4:32		4:38	4:45		4:51	4:58		5:04	5:11
Oswego	SRA	4:39		4:45	4:52		4:58	5:05		5:11	5:18
Central Square JV	SRA	4:46		4:52	4:59		5:05	5:12		5:18	5:25
CNS Northstars Jr	IRA	4:53		4:59	5:06		5:12	5:19		5:25	5:32
Southern Tier	IRA	5:00		5:06	5:13		5:19	5:26		5:32	5:39
Heritage Hurricanes	Exh	5:08		5:13	5:21		5:26	5:34		5:39	5:47

Intermission 5:47 - 6:17

Guard	Class	Ready	Travel	Body Warm-up start	Body Warm-up end		EQ Warm-up start	EQ Warm-up end	Travel	Perform Start	Perform End
Phoenix JV	SA-3	5:46		5:51	5:59		6:04	6:12		6:17	
Corning Painted Post	SA-3	5:54		5:59	6:07		6:12	6:20		6:25	
Westmoreland Sr	SA-3	6:02		6:07	6:15		6:20	6:28		6:33	
Greater Johnstown	SA-2	6:10		6:15	6:23		6:28	6:36		6:41	
Jordna Elbridge Varsity	SA-2	6:18		6:23	6:31		6:36	6:44		6:49	
Laurens	SA-2	6:26		6:31	6:39		6:44	6:52		6:57	
CNS Northstars JV	SA-2	6:34		6:39	6:47		6:52	7:00		7:05	
Judges Break										7:13	
Introspection	IA	6:47		6:52	7:00		7:05	7:13		7:18	
Liverpool Varsity	SA-1	6:55		7:00	7:08		7:13	7:21		7:26	
ESM Varsity	SA-1	7:03		7:08	7:16		7:21	7:29		7:34	
Judges Break										7:42	
Victor	SO	7:17		7:21	7:30		7:34	7:43		7:47	
Central Square Varsity	SO	7:26		7:30	7:39		7:43	7:52		7:56	
Judges Break										8:05	
CNS Northstars Varsity	SW	7:41		7:44	7:54		7:57	8:07		8:10	
Retreat/Awards										8:20	

Retreat - Captains line up for awards in the Equipment Warm-up gym as soon as CNS Varsity finishes performing.

The CNS Winter Guard Colors in Motion/Music Winterguard Show

Homeroom Agreement

Date: _____

Guard Name: _____

Name: _____

(please print)

As the representative for the above named unit, I agree to return the homeroom to which we have been assigned to the condition in which it was found. Further, I understand that any electronic devices that may be in the room (i.e. computer, TV) are not to be used.

I also understand that the unit's Director and/or the Director's organization will be held responsible for any damages or missing items.

I will not open, touch or go through the teacher's desk or any closed files and will not allow the use of glitter in the assigned room.

I understand that the guard must exit the room within 45 minutes after the end of retreat. If more time is needed, guards may wait in cafeteria.

Homeroom Assigned: _____

Signature: _____

Title: _____

FLOOR CREW / STAFF / CHAPERONE SIGN IN SHEET

GUARD_____ Class_____

1. _____

2. _____

3. _____

4. _____

5. _____

6. _____

7. _____

8. _____

9. _____

10. _____

11. _____

12. _____

13. _____

14. _____

15. _____

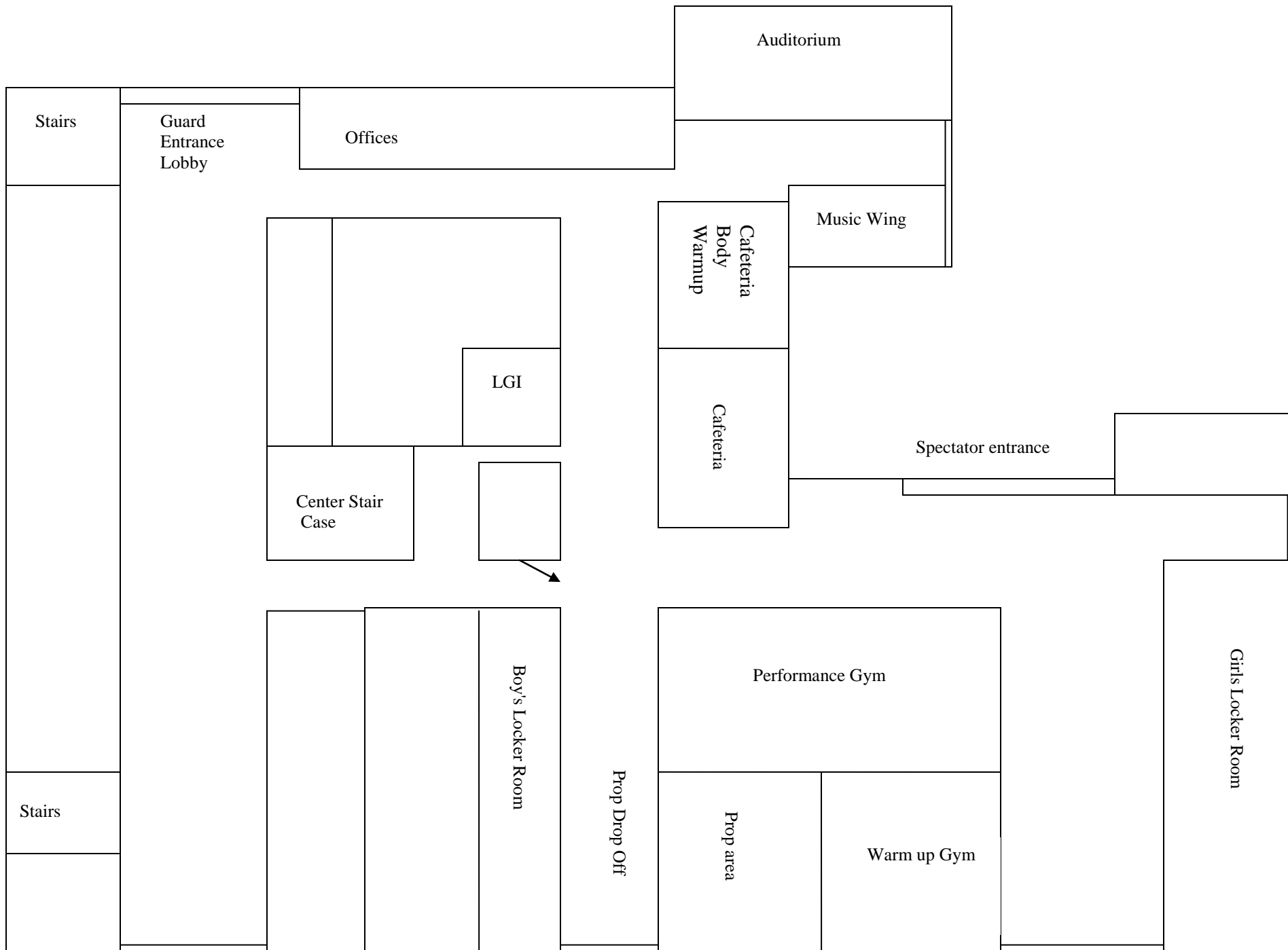

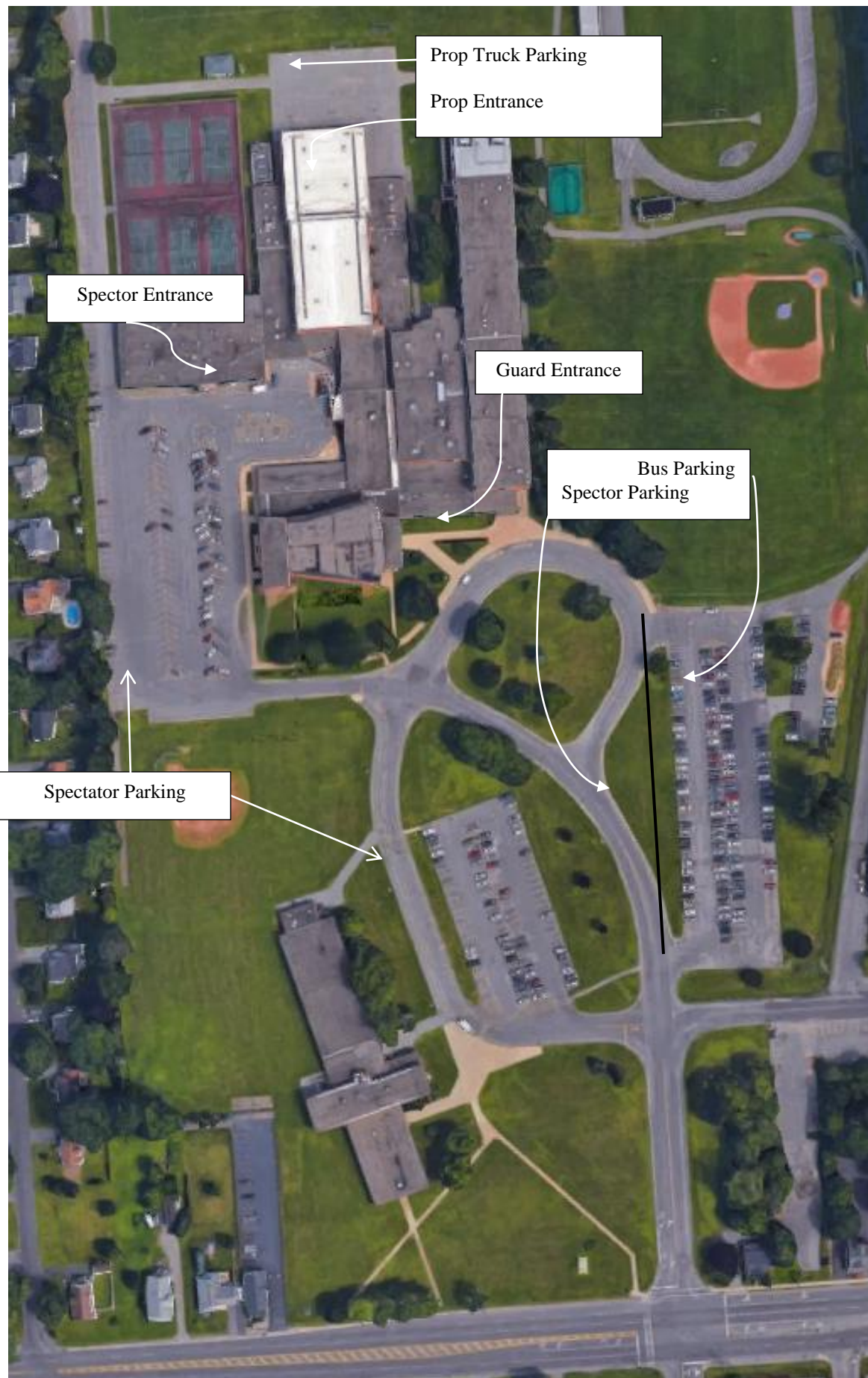

Prop Truck Parking
Prop Entrance

Spector Entrance

Guard Entrance

Bus Parking
Spector Parking

Spectator Parking

Picture of placement of speakers and backboards. Our floor mat is 50 by 80 feet. As you can see the backboards are just over the floor mat on either side. There are 2 speakers over the floor. They are in line with the hoops. We plan to not fully open the back bleachers to help guards shift floor mats back to help.

